

To: All Distributors
Regional Sales Managers and National Sales Manager

From: Technical Support

Model: Mini Rear Loader

Subject: Carrier Shimming Procedure

Side-to-side travel of the carrier & packer during travel may cause the packer to contact the tailgate side walls. The addition of shims behind the slide shoes will minimize the side-to-side travel to resolve this.

Shimming of the lower slide shoes is a fairly simple procedure and may be performed with minimal disassembly by driving the shoe pins (also the packer pivot pins) inward to both remove the slides and install the shims.

Be sure to follow all appropriate lockout tag out procedures and work instructions as contained in service and repair manuals as well as your standard shop/facility procedures before attempting this procedure.

Check the orientation of the slide shoes. The UHMW slides are offset on the steel shoe holder; the offset edge should be facing outward.

Flat edge
toward carrier.



Offset edge toward
track channel.

- Operate the packer/carrier through several cycles to determine the number of shims needed to correct any side movement of the assembly during or at either end of their travel. Shimming the slide shoes must be limited to avoid rubbing on the vertical face of the tailgate track channel. The point where the slide shoe is closest to the vertical face of the track channel will dictate the maximum number of shims to be used.
- Place the packer panel in the folded (cylinders extended) position, and the carrier in the lowered (cylinders extended) position. Perform all applicable lockout / tagout procedures.

Use a lifting device at the lower carrier lifting eye, raise it just to the point of relieving the weight on the slide shoes.



Remove the lower access covers on the outside of the tailgate channels.



Remove the access covers on the lower channel of the carrier panel then remove the packer pin retainers.



Drive the packer pin inward, just to the point of allowing removal of the slide shoe.



Place the shims onto the pin as shown below

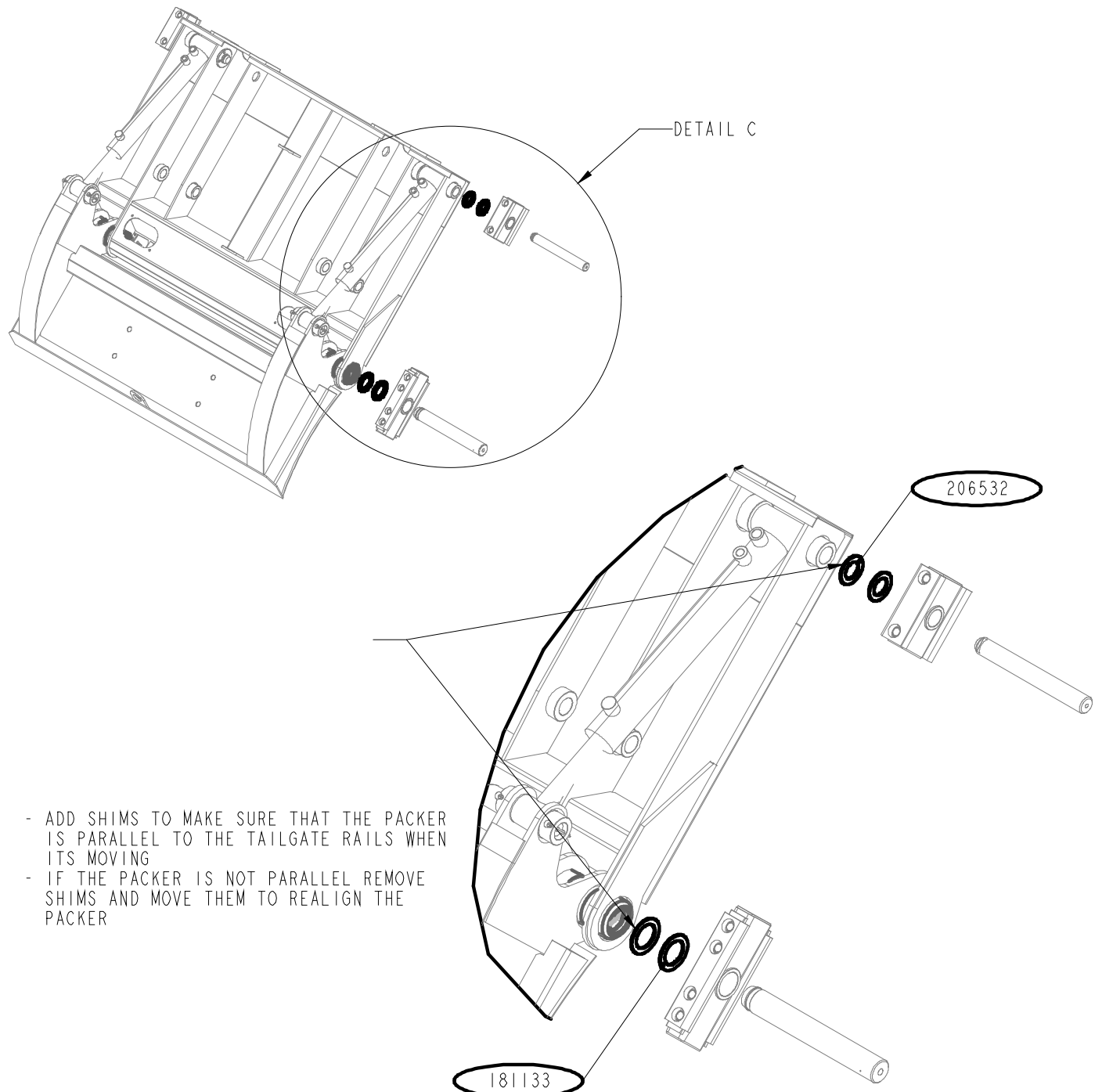

- Place the slide shoe back into position and tap the pin outward until in proper position (2 people required).
- Install the packer pin retainers, all covers and tighten hardware.

The upper slide shoes cannot be done in the same manner; due to interference of the carrier cylinders; the shoe pins (which are also the packer case end cylinder pins) must be pulled outward with a slide hammer; this will require supporting of the packer cylinder in addition to supporting the carrier panel during the process.

Please contact the LabriePlus Service Department at (800) 231-2771 with any questions or for further information.