

To: All Distributors
Regional Sales Managers and National Sales Manager

From: LabriePlus Service

Model: RL

Subject: HYP00182 Piggyback Pump Replacement

The HYP00182 piggyback pump used on Leach Rear Loaders has been discontinued by the supplier. SERV02903 has been created to replace HYP00182. The kit includes a new pump assembly, dry valve and associated fittings needed to convert from the HYP00182 pump since the suction port is now 2" on the new pump.

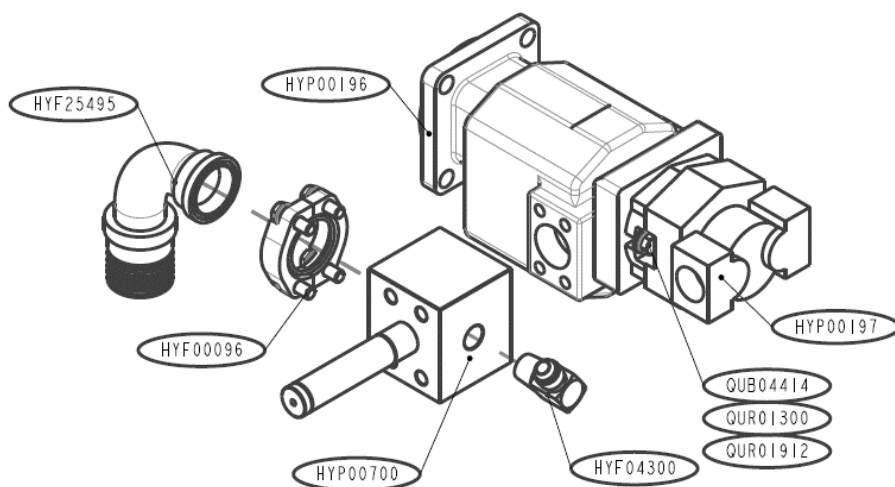

Please contact the LabriePlus Service Department at **(800) 231-2771** for questions or further information