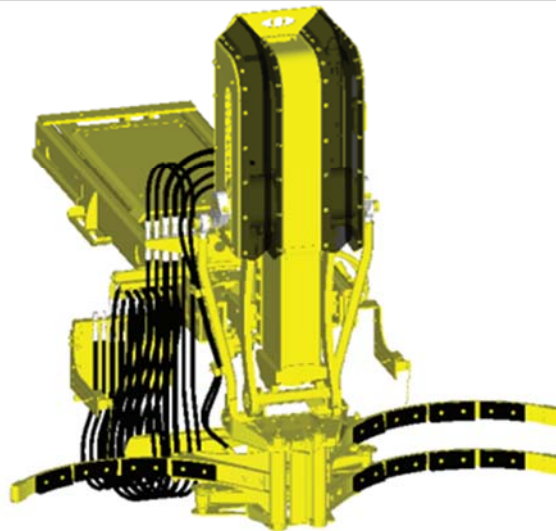

To: All Distributors
Regional Sales Managers and National Sales Manager

From: LabriePlus Service

Model: Heavy Duty Right Hand Arm

Subject: Lubrication of Arm and Chains

In normal service, the Labrie Heavy Duty Right Hand Arm will dump thousands of carts per week, and therefore needs to be lubricated weekly for proper operation and long life. Every Labrie unit will come with 2 grease charts on the sides of the unit, one for the body and one for the arm. This bulletin will focus on the arm chart for the Labrie Right Hand.



Please contact the LabriePlus Service Department at (800) 231-2771 (US) or (877) 452-2743 (CAN) for questions or further information

LUBRICATION CHART, Right-Hand™ ARM

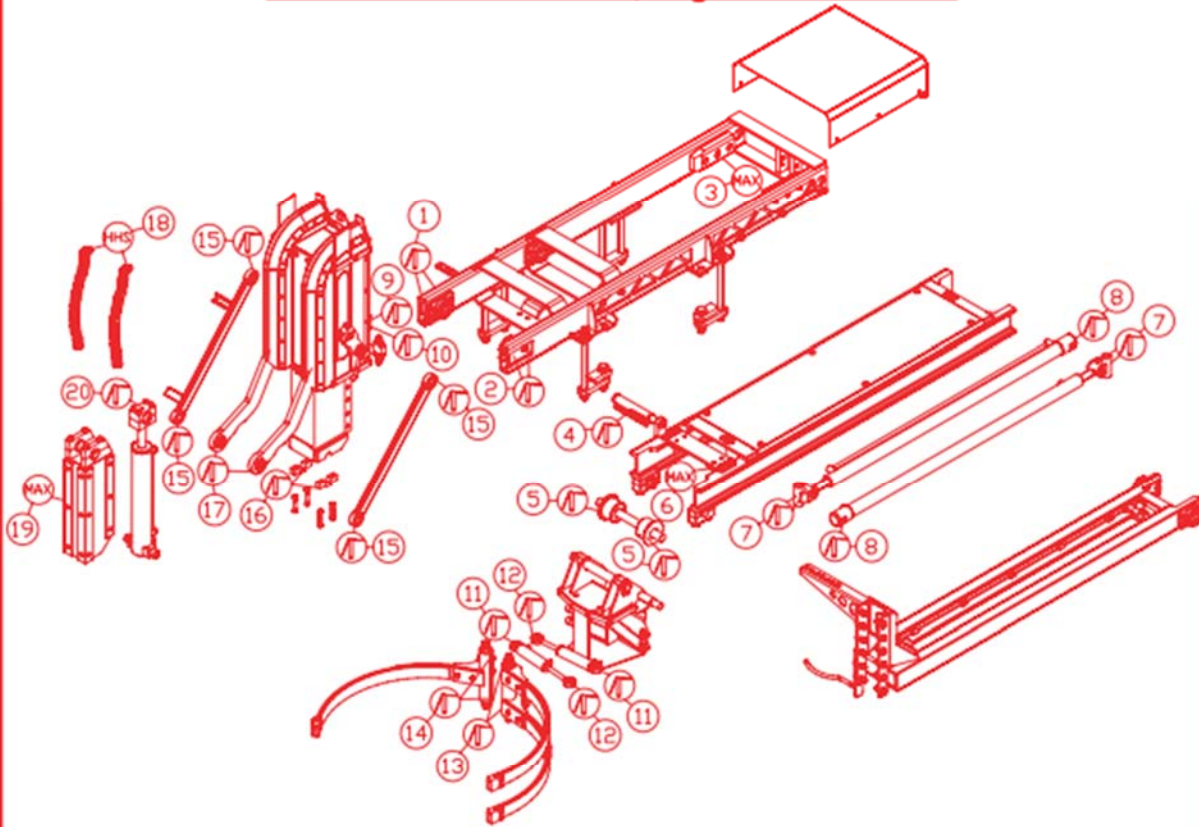

LUBRICATION CHART		
NO.	DESCRIPTION	FREQUENCY
1	LEFT OUTER RAIL ROLLER BEARING	WEEKLY
2	RIGHT OUTER RAIL ROLLER BEARING	WEEKLY
3	OUTER RAIL TEFLON GUIDE (MAX EP)	WEEKLY
4	CENTER RAIL HOSE HOLDER	MONTHLY
5	CENTRAL RAIL ROLLER BEARING	WEEKLY
6	CENTRAL RAIL TEFLON GUIDE (MAX EP)	WEEKLY
7	HOIST CYLINDER ROD END	WEEKLY
8	HOIST CYLINDER BUSHING	WEEKLY
9	LEFT INNER RAIL ROLLER BEARING	WEEKLY
10	RIGHT INNER RAIL ROLLER BEARING	WEEKLY
11	GRIPPER CYLINDER BUSHING	WEEKLY
12	GRIPPER CYLINDER ROD END	WEEKLY
13	GRIPPER RIGHT BLADE PIVOT	WEEKLY
14	GRIPPER LEFT BLADE PIVOT	WEEKLY
15	GRIPPER LEVELING BARS	WEEKLY
16	OUTER POST BOTTOM PLATES	WEEKLY
17	GRIPPER UP/DOWN ARM	WEEKLY
18	LOAD CHAIN (WURTH-HHS-2000)	WEEKLY
19	INNER POST TEFLON PLATE (MAX EP)	WEEKLY
20	UP/DOWN CYLINDER ROD END	WEEKLY

USE ALL PURPOSE COMMERCIAL LITHIUM BASE GREASE.
NEVER APPLY GREASE ON THE WEAR PLATES. USE MAX EP LUBRICANT OR DISH WASHING SOAP.

LEGEND:



ANY LITHIUM BASE GREASE



MAX EP LUBRICANT



WURTH-HHS-2000 LUBRICANT

Rev. 2

LABRIE

47702

Please contact the LabriePlus Service Department at **(800) 231-2771 (US)** or **(877) 452-2743 (CAN)** for questions or further information

When you look at this chart you will notice 3 different lubricants, these all have their specific function. Also, the chart will be divided into 3 different categories.

LUBRICATION CHART		
NO.	DESCRIPTION	FREQUENCY
1	LEFT OUTER RAIL ROLLER BEARING	WEEKLY
2	RIGHT OUTER RAIL ROLLER BEARING	WEEKLY
3	OUTTER RAIL TEFLON GUIDE (MAX EP)	WEEKLY
4	CENTER RAIL HOSE HOLDER	MONTHLY
5	CENTRAL RAIL ROLLER BEARING	WEEKLY
6	CENTRAL RAIL TEFLON GUIDE (MAX EP)	WEEKLY
7	IN/OUT CYLINDER ROD END	WEEKLY
8	IN/OUT CYLINDER BUSHING	WEEKLY
9	LEFT INNER RAIL ROLLER BEARING	WEEKLY
10	RIGHT INNER RAIL ROLLER BEARING	WEEKLY
11	GRIPPER CYLINDER BUSHING	WEEKLY
12	GRIPPER CYLINDER ROD END	WEEKLY
13	GRIPPER RIGHT BLADE PIVOT	WEEKLY
14	GRIPPER LEFT BLADE PIVOT	WEEKLY
15	GRIPPER LEVELING BARS	WEEKLY
16	OUTTER POST BOTTOM PLATES	WEEKLY
17	GRIPPER UP/DOWN ARM	WEEKLY
18	LOAD CHAIN (WURTH-HHS-2000)	WEEKLY
19	INNER POST TEFLON PLATE (MAX EP)	WEEKLY
20	UP/DOWN CYLINDER ROD END	WEEKLY
USE ALL PURPOSE COMMERCIAL LITHIUM BASE GREASE. NEVER APPLY GREASE ON THE WEAR PLATES; USE MAX EP LUBRICANT OR DISH WASHING SOAP		

LEGEND:



ANY LITHIUM BASE GREASE



MAX EP LUBRICANT



WURTH-HHS-2000 LUBRICANT

- **“NO.”** This will be correlated with the numbers on the picture of the arm and will show you where the grease point is.
- **“DESCRIPTION”** will tell you which lubricant to use.
- **“FREQUENCY”** tells you on how often you should be greasing this part, this is based on 800 container lifts per day.

The first type of lube used is **Lithium-Based Grease**. Labrie recommends using a quality **lithium-based EP-2 (NLGI Grade 2) grease**. This will give you the best protection in all climates. This grease will be used on most parts of the arm except for a couple which will be covered in this bulletin.

Second is **Max EP Lubricant**, this will be used on any of the Teflon plates on the RH arm. (3, 6, and 19).

Last is **Wurth-HHS-2000 Lubricant**, this will be applied to the load chains (#18).

Note: Some Right-Hand Arms are equipped with Auto Lube systems, either factory or Distributor installed. Please refer to the documentation provided with the system for operation, maintenance, and type of lube to use. Inspect Auto Lube system daily to insure proper operation. Faulty Auto Lube systems can quickly wear and damage arm components. Also note that Auto Lube systems do not lubricate the Teflon plates or the load chains. These still need to be lubricated per the chart above.

Please contact the LabriePlus Service Department at **(800) 231-2771 (US)** or **(877) 452-2743 (CAN)** for questions or further information