

To:

From: LabriePlus

Model: LEACH™ Alpha-III and 2R-III

Subject: Carrier Panel Roller and Slide Shoe Lubrication

Leach units may be equipped with carrier panel sliding wear shoes or rollers. All follower panel rollers will each have a center grease zerk fitting. Depending on the model and year of units with sliding shoes two or four of the shoes will be equipped with a center grease zerk. In either case the sliding shoes or rollers must be lubricated twice weekly. There are two upper shoes and two lower shoes installed in the carrier panel. See description below :

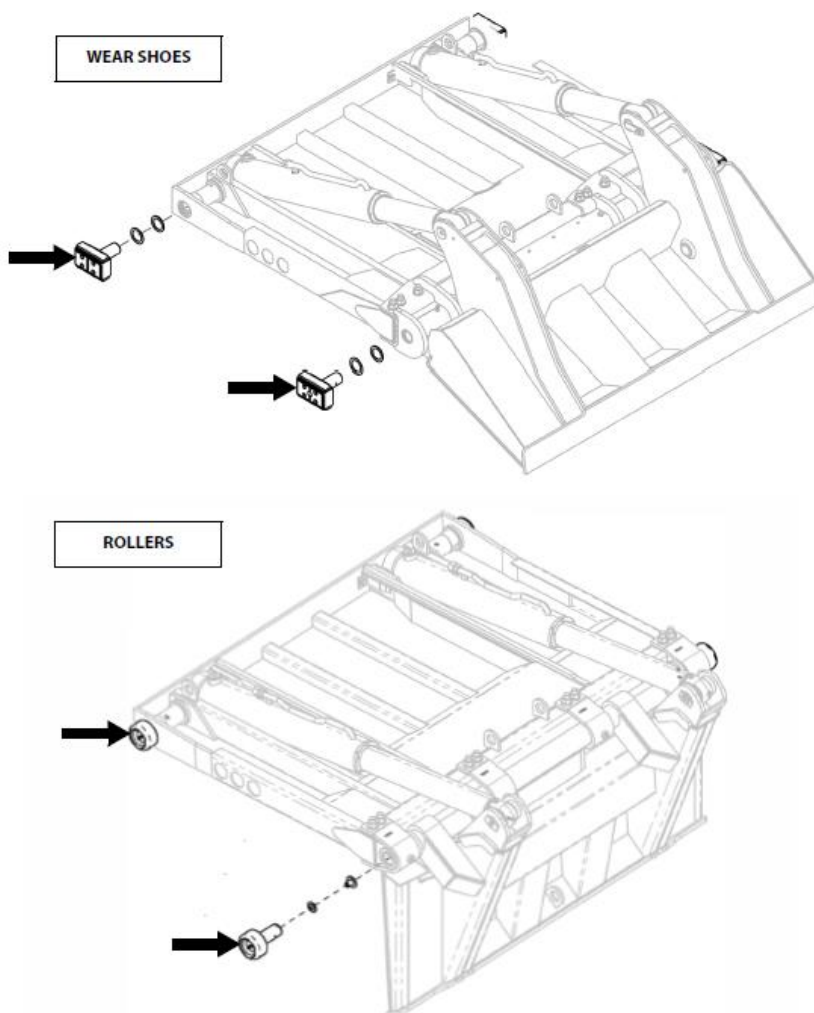

Please contact the LabriePlus Service Department at (800) 231-2771 (US) or (877) 452-2743 (CAN) for questions or further information

On units equipped with carrier panel slide shoe design it is recommended that the track channel be lubricated to prevent unwanted noise and increased service life. Use Labrie part number LUG00100 or an open lube gear spray can also be used. Note that with all new sliding shoe equipped Leach™ units a can of LUG00100 is shipped in the can bracket of the ejector panel for this purpose.

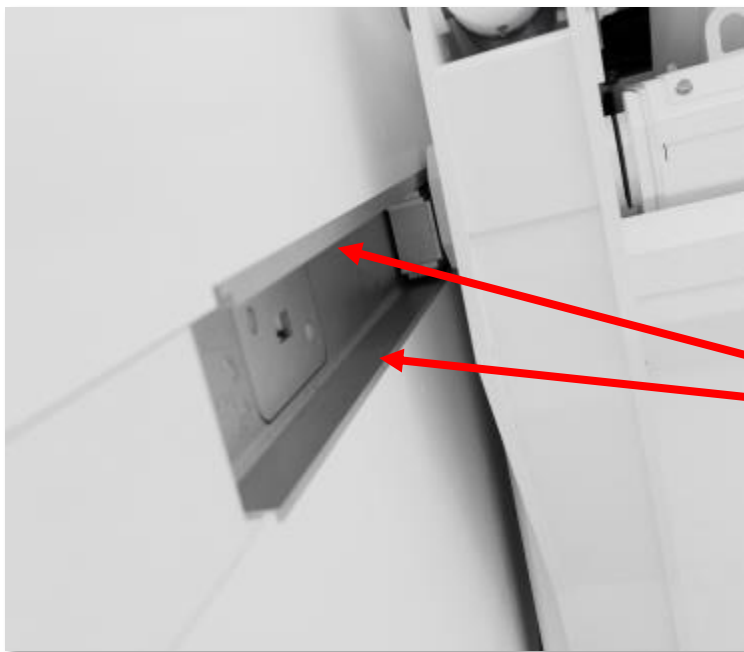

SUGGESTED BRAND

***Note: On units equipped with carrier rollers the track channels should NOT be lubricated.***

Please contact the LabriePlus Service Department at **(800) 231-2771 (US)** or **(877) 452-2743 (CAN)** for questions or further information